

1 CONSTRUCTION DIAGRAM

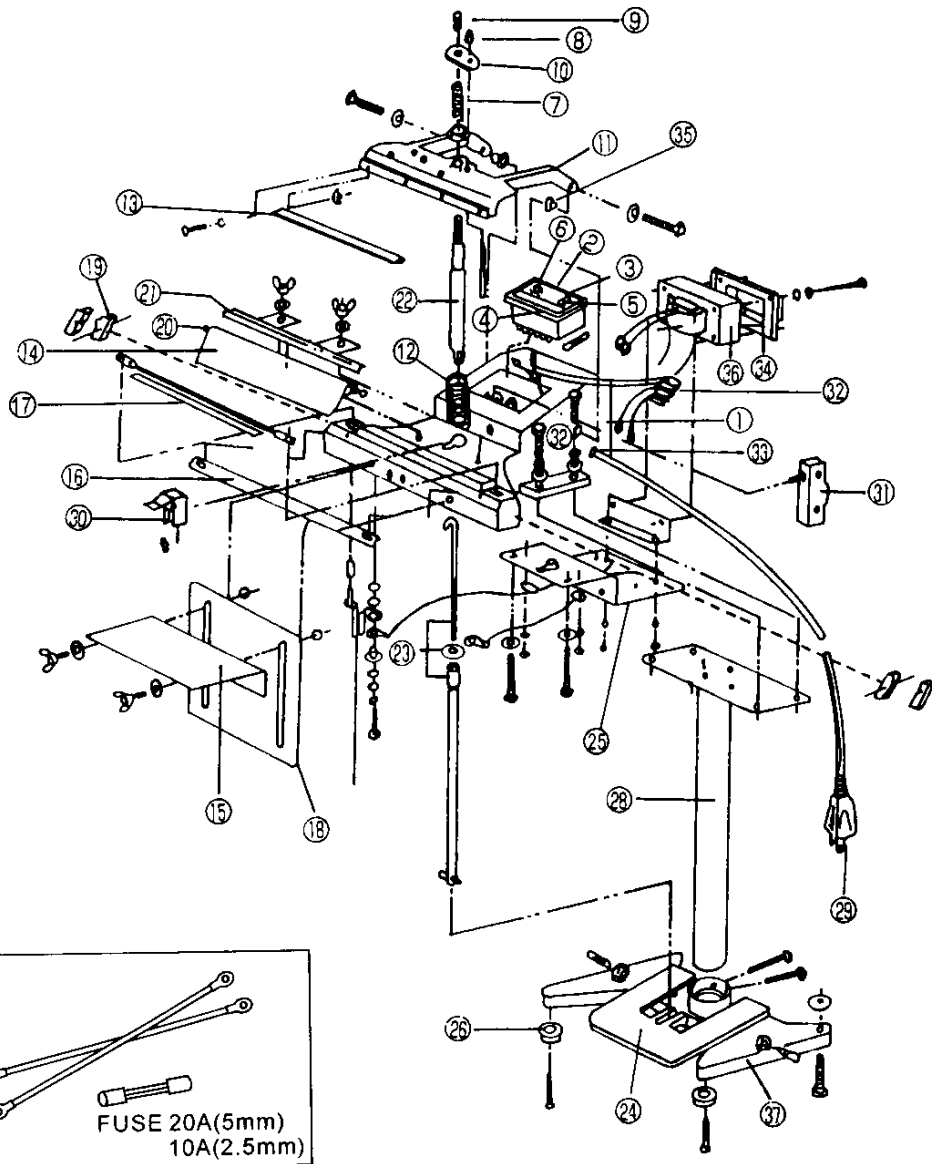

2 PARTS LIST

- | | |
|--------------------------|------------------------------|
| 1.ENCLOSURE | 19.HEATING TERMINAL ASSEMBLY |
| 2.TIMER CONTROL | 20.METAL BAR FOR CLOTH |
| 3.PILOT LAMP | 21.CLIP FOR TEFLON CLOTH |
| 4.FUSEHOLDER | 22.UPPER LEVER |
| 5.POWER SWITCH | 23.DOWN LEVER |
| 6.TIMER KNOB | 24.FOOT PEDAL |
| 7.PRESSING SPRING | 25.BOTTOM COVER PLATE |
| 8.SETTING BOLT NUT | 26.RUBBER FOOT |
| 9.UPPER LEVER NUT | 27.RELAY |
| 10.FIX PLATE | 28.STANDING TUBE |
| 11.UPPER JAW | 29.POWER SUPPLY CORD |
| 12.UPPER JAW SPRING | 30.INTERLOCK SET |
| 13.SILICONE RUBBER PAD | 31.LIMITED SWITCH |
| 14.UPPER TEFLON CLOTH | 32.CONNECTOR |
| 15.WORKING PLATE | 33.STRAIN RELIEF BUSHING |
| 16.UPPER CLOTH FIX PLATE | 34.TRANSFORMER COVER |
| 17.LOWER HEATER CLOTH | 35.HINGE FOR UPPER JAW |
| 18.LEVEL PLATE | 36.TRANSFORMER |
| | 37.PEDAL BASE |

3 CONNECTION DIAGRAM

